

Mobile Discone Antenna
For Reception 100 - 1600MHz Wide Band Non-Directional Antenna
Available for transmitting for the range 144/430/904/1200MHz)

DIAMOND
ANTENNA

D220

Operation Instructions

To use this antenna properly, read this instruction thoroughly before using it. Keep this manual carefully at hand for later use.

Antenna Location

D220 doesn't require any ground plane. However, for your safety, fix the antenna base on the car firmly. Don't use the magnet antenna base.

Trunk Lid

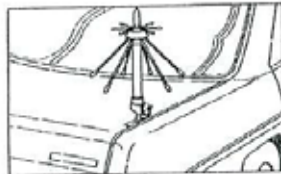

Gutter Mount

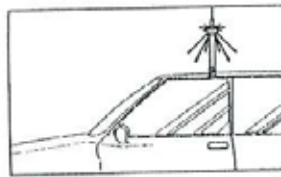

For uses

D220 is a wide range 100-1600MHz receiving antenna. It is available for transmitting for 144/430/904/1200MHz.

D220 is designed as a mobile antenna but it is possible to use D220 as fixed station with Diamond Antenna Brand BK10.

Note

- Don't touch the antenna during transmitting.
- Install the antenna within total width and length of the car and the place where is not easy reachable.
- Don't use the magnet antenna base.
- Bolts and screws on the antenna and antenna bracket are likely to be loosened by vibration during driving. Be sure to see if they are well fastened before operation and refasten them if needed.
- For your safety, remove the cap from the disk element. Cap of cone elements are adhered and cap of disk elements are not adhered.

Note

- If D220 is too close to other antenna, VSWR may be higher. Please install the antenna from other antenna as far away as possible.
- If the antenna is installed close to broadcasting stations, sometimes you are not able to receive the signal.

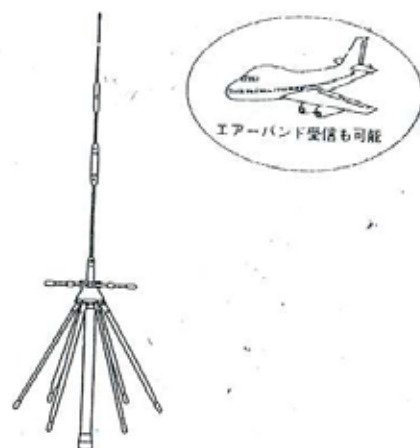

Mobile Discone Antenna
For Reception 100 - 1600MHz Wide Band Non-Directional Antenna
Available for transmitting for the range 144/430/904/1200MHz)

Check for the parts

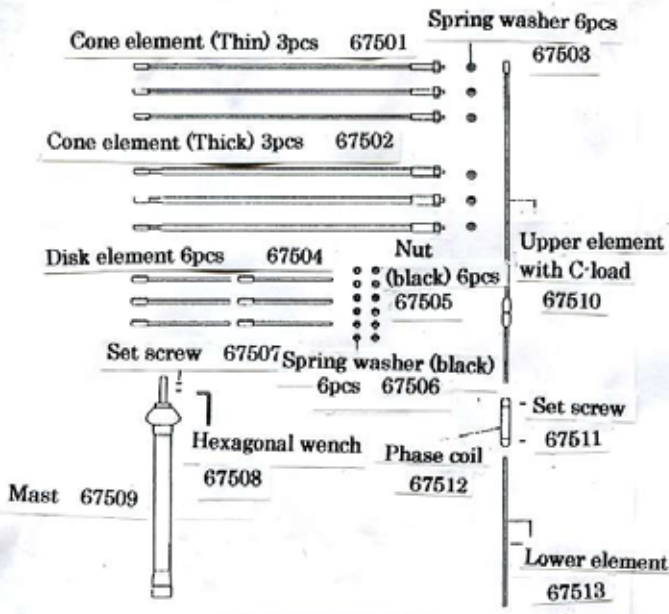

③ All 6 pieces of cone element should be mounted. [note] Please attach thin cone element and thick element alternately. Two kinds of cone elements are included. One is thin cone element and another is thick cone element.

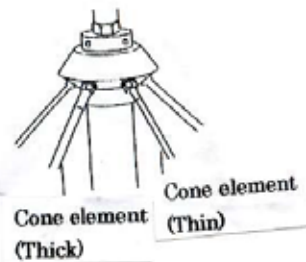

④ Attach the nut to disk element. The nut should be fastened to end of screw.



How to assembly

① Fix the upper element with Hexagonal wench. Nuts and screw can be loosened by vibration during driving.

② Attach the cone element and spring washer to cone base. After setting by hand then fasten firmly by 8mm spanner.

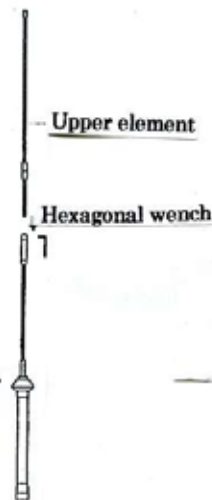
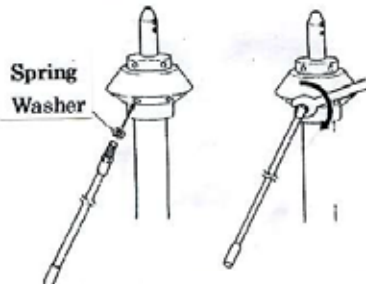

⑤ Attach disk element and spring washer to disk base. After setting by hand then fasten firmly by 7mm spanner.

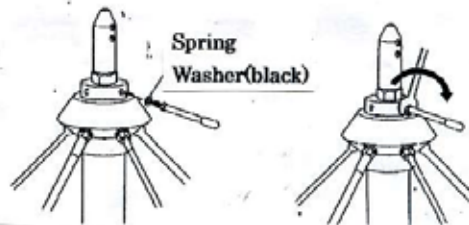

⑥ All 6 pieces of cone elements should be mounted.

Mobile Discone Antenna
For Reception 100 - 1600MHz Wide Band Non-Directional Antenna
Available for transmitting for the range 144/430/904/1200MHz)

Specifications

Receiving Frequency range	100-1600MHz
Transmitting Frequency range	144/430/904/1200MHz
Gain	2.15dBi (144/904/1200MHz) 5.5dBi (430MHz)
Impedance	50 Ω
VSWR	Less than 1.5
Max Power rating	50 W
Length	0.90m
Weight	385g
Max Diameter	21.6cm
Connector	M
Type	$1/2 \lambda$ (144MHz), $2 \times 5/8$ (430MHz)

- Though the product purchased are manufacture under strict quality control. If damage is caused by transporting, ask the dealer promptly.
- Design and specification of the product will be changed for future improvement without advance notice.